

Location of GridKa School

GridKa School takes place at the Campus North of Karlsruhe Institute of Technology (KIT), at the premises of FTU (Fortbildungszentrum Technik und Umwelt). FTU is located on the left side directly in front of KIT Campus North main gate.

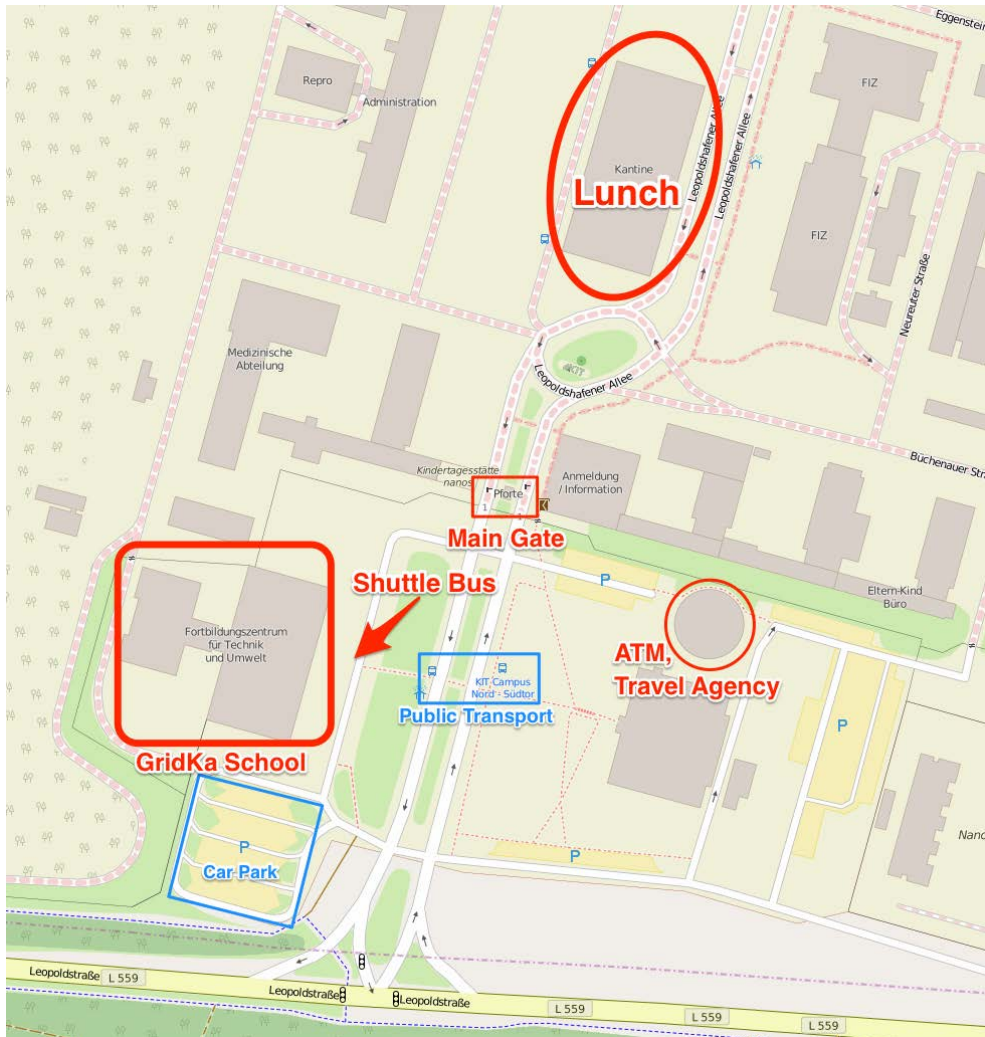

How to get to KIT Campus North (and back to the hotel)

There are three ways to get to KIT and back: by shuttle bus, by public transport and by car (there are parking lots available). The shuttle bus is recommended. Further information is given at "How to reach GridKa School event location".

Bus shuttle from Karlsruhe to conference location and back

Monday, 26.08.2019

12:30 departure from Leonardo Hotel Karlsruhe via main railway station (south exit bus station), departure ~ 12:35 to the GridKa School location. Be sure that you are on the South side – if you see trams you are on the wrong side of the main station. You can also check the location on Google Maps <https://goo.gl/maps/20FE5>.

There will be a big sign “Kasper” on the buses.

18:00 transfer back to Leonardo Hotel

Tuesday, 27.08.2019

8:15 departure from Leonardo Hotel to the school location

22:00 transfer back to Leonardo Hotel (Buses will leave at SCC (Tarte Flambée Event Location!))



Wednesday, 28.08.2019

8:15 departure from Leonardo Hotel to the school location

20:30 transfer back to Leonardo Hotel

Thursday, 29.08.2019

8:15 departure from Leonardo Hotel to the school location

18:00 transfer back to Leonardo Hotel

Friday, 30.08.2019

8:15 departure from Leonardo Hotel to the school location

12:00 transfer to railway station

Access to the KIT Campus North site for lunch and the social event

KIT maintains a rather high level of security (it was the location of the first German nuclear research system and still has a few nuclear installations on-site). For the daily lunch and for the social event on Tuesday evening you need to enter the KIT Campus North site. To avoid inconvenient queuing in line at the entrance we have already pre-registered you, that is why you were asked for date and place of birth in the online registration form. To enter the site just show your GridKa School badge to the guards. Please carry with you your passport (for citizens of European Union a regular ID card is also accepted) all the time.

Lunch and coffee breaks

You will be offered coffee, tea, cookies, fruits and refreshments during the whole school at FTU. Lunch is available at the casino located on-site at KIT Campus North. You need to bring along your GridKa School badge to enter the site, please do not leave it in the hotel. The lunch is only partly included in the school fee. In your welcome package for GridKa School you receive a rechargeable card for cashless payment, KIT participants use their own identity card. The rechargeable card is pre-loaded with 10,00 EUR (including 2,50 EUR deposit). You can use one of the vending machines in the casino to recharge your card. Please note that an additional fee of 30% is charged on the announced prices for guests. Make sure to return this card at the end of GridKa School in the school office or in the badge return box.

Opening hours casino

Casino

11:30 - 14:00

Bistro (same building)

7:00 - 18:30, meals until 18:00

Electric power

We will provide a sufficient number of power sockets for all participant notebooks.

For participants from abroad: please be aware that the plugs in use are of CEE-7/7 system. German standard for current supply is 230V/50Hz.

For all hands-on sessions, you will need a laptop. Please do not forget to bring your laptop to the conference.

Your laptop needs to provide an ssh client, a web browser (Firefox advised) and a working WiFi; root privileges are highly encouraged.

Guest WLAN access for GridKa School 2019

You will find your guest username with the associated password and instructions in your GridKa School welcome package. This account is valid for the entire GridKa School.

In addition, "eduroam" network is also available in the GridKa School rooms.

GridKa School Survey

To keep the technical program of the school at highest quality and make it more attractive and exciting in future the school organizing team has prepared a short survey on school talks, sessions and general organization. We will provide the link via email to the participants.

Rooms for parallel courses from Tuesday until Thursday:

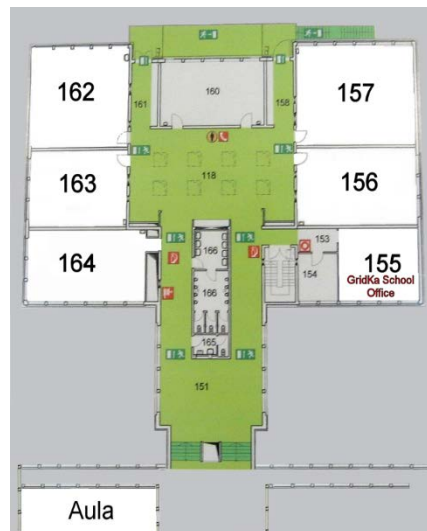

Evening Program

Tuesday evening

One of GridKa School's traditions is the "Tarte Flambée" (an Alsatian speciality made from a very thin layer of pastry topped with sour cream, chopped onions and bacon) served at the informal social event on Tuesday evening. Beer and alcohol-free beverages will be provided. After the Tuesday sessions, we will meet in front of the FTU and go together through the KIT gate to the event place.

Wednesday evening

The evening lecture is another highlight of GridKa School. The evening lecture is open for GridKa School participants as well as everybody else that is interested. Dr. Peter Bauer will present "Why the future of weather and climate prediction will depend on supercomputing, big data handling and artificial intelligence". The evening lecture will take place in the Aula at FTU.

Thursday evening

The school dinner is the annual highlight of GridKa School's evening program. It will take place in the Leonardo Hotel Karlsruhe.

Contact e-mail address and phone number

If you have any questions, please write an e-mail to GridKa-School@scc.kit.edu.

Contact number during the school: +49 172 344 23 19